



Broomfield Road, Coventry

Offers Over £290,000 Freehold

Exceptional 3 Bedroom Mid-Terrace | High Spec Finish | Ready to Move Into

Description

A beautifully presented three-bedroom mid-terrace home, ideally positioned on the sought-after Broomfield Road, offering stylish, turn-key living, generous proportions throughout, and a superb rear garden, perfect for modern family life.

Set along a popular residential road, the property benefits from on-street parking with good availability for residents and visitors, along with an attractive frontage that immediately sets the tone for what lies within.

Internally, the home has been thoughtfully maintained and presented to a high standard throughout. A welcoming entrance hallway leads into a bright and spacious living room, creating a warm and inviting setting for both relaxing and entertaining.

To the rear, the property truly comes into its own with a stunning kitchen/diner, complete with underfloor heating, providing a luxurious and comfortable space ideal for everyday living. The dining area is finished with high-quality engineered oak flooring, adding a premium touch and enhancing the overall feel of quality throughout the home.

Further benefits include a Hive smart heating system, allowing convenient and energy-efficient temperature control throughout the property.



Enhancing the practicality of the home is a downstairs cloakroom, along with a cleverly designed hidden utility area, allowing for additional storage and functionality without compromising on space or style. With direct access to the garden, the kitchen/diner is perfectly suited for hosting and family gatherings.

Upstairs, the property offers three generously sized bedrooms, including well-proportioned doubles, all beautifully presented and ready to move straight into. A modern family bathroom serves all rooms, finished to a clean and contemporary standard.

Externally, the property boasts a spacious rear garden, mainly laid to lawn, offering the perfect space for outdoor entertaining, families, or simply enjoying the warmer months.

This is a true turn-key home, ideal for buyers looking to move straight in without the need for any work, combining comfort, style, and practicality in a highly desirable location.

Situated within easy reach of local amenities, well-regarded schools, and excellent transport links, Broomfield Road is a popular and convenient setting, making this an opportunity not to be missed.

Council Tax Band: B

Tenure: Freehold

Garden details: Private Garden

Tenure

Freehold

Approx Gross Internal Area
96 sq m / 1051 sq ft

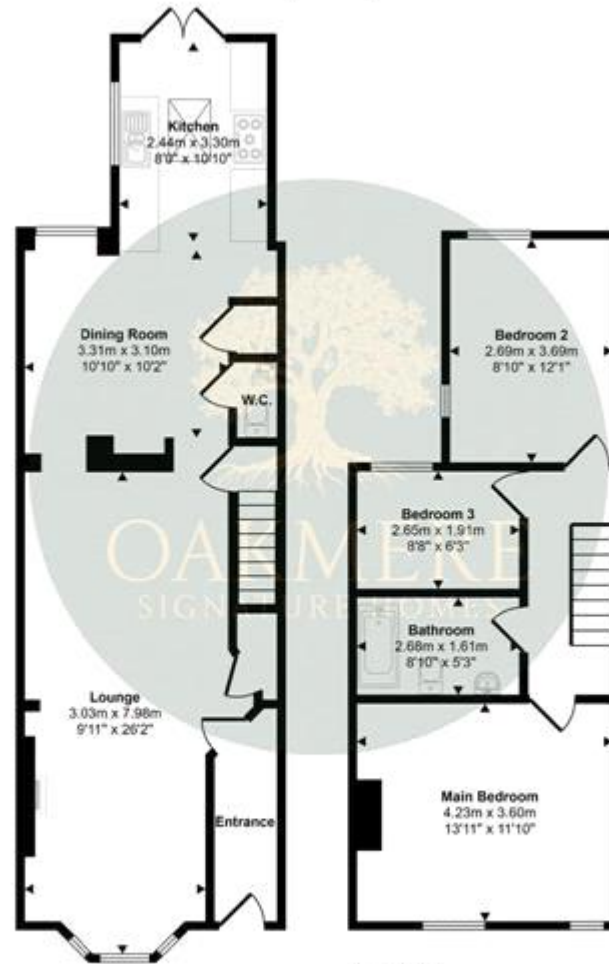

Ground Floor
Approx 56 sq m / 602 sq ft

First Floor
Approx 42 sq m / 449 sq ft

This floorplan is only for illustrative purposes and is not to scale. Measurements of rooms, doors, windows, and any items are approximate and no responsibility is taken for any error, omission or mis-statement. Icons of items such as bathroom suites are representations only and may not look like the real items. Made with Made Snappy 360.



Energy Efficiency Rating		
	Current	Potential
Very energy efficient - lower running costs		
(92+) A		
(81-91) B		87
(69-80) C	74	
(55-68) D		
(39-54) E		
(21-38) F		
(1-20) G		

Viewing by appointment only
 Oakmere Signature Homes Ltd - Head Office
 Friars House, Manor House Drive, Coventry, West Midlands CV1 2TE
 Tel: 02477360410 Email: gurpal@oakmeresignaturehomes.com Website:

